



# No Men Allowed

Peekaboo looks for male DNA to determine your baby's gender. Please ensure that males (even male pets) do not come into contact with kit contents. Clean all surfaces with either bleach or soap and warm water before testing to help prevent contamination.



## The Peekaboo Promise & Guarantee

We know how important this test is to you and promise to provide the earliest, fastest, and most accurate gender DNA test result on the market. We're so confident in the Peekaboo test that we offer a 100% money-back guarantee if the gender of your newborn doesn't match your result.



To learn more about our Money Back Guarantee policy visit [peekaboogendertest.com/return-policy/#guarantee](https://peekaboogendertest.com/return-policy/#guarantee)

The test has not been validated on multi-fetal pregnancies and in these cases its accuracy is unknown. If there is not enough fetal DNA in the mother's bloodstream to perform testing at six weeks, we'll provide testing materials for sample recollection at no charge.



© 2023 DNA Diagnostics Center (DDC) · All Rights Reserved. Peekaboo is a product of DDC – world leader in DNA relationship testing.  
PKB-DTC-US-IFU-Mar.15.2023

## Let's Get Started



**REGISTRATION IS REQUIRED**  
to Obtain your Result.



Scan the QR Code with your phone's camera app or go to [PeekabooGenderTest.com/Register](https://PeekabooGenderTest.com/Register)

## PREPARATION

### 1 Prepare for Sample Collection

- Locate a level surface to collect your sample.
- Clean surface with household cleaner or warm soapy water.
- Drink a full 8-ounce glass of water 20 minutes before starting.



### 2 Sanitize Hands

- Wash hands with warm water and soap for 30 seconds and air-dry by shaking your hands.
- Prevent contamination by not touching anything except test items.

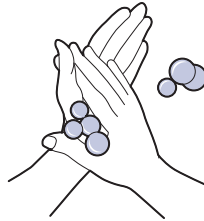

After washing hands, turn water off with your **elbow** to avoid any contamination. Do **NOT** dry hands on a communal towel.

### 3 Remove Items from Box

Remove and place the following items on the clean surface: Two alcohol wipes, three lancets, one collection tube, two bandages and one resealable bag.

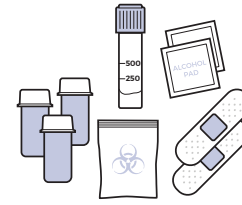

### 4 Preparing the Collection Tube

The collection tube contains a small amount of liquid preservative. Hit the bottom of the tube on the table three (3) times to collect the liquid at the bottom. **It is critical that liquid preservative droplets NOT be removed from the tube.**

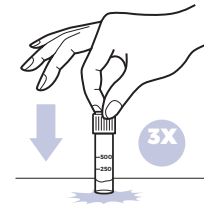

### 5 Set Up Collection Tube

Punch out perforated circle in the Test box and place on clean surface with hole facing up. Twist off the tube cap, and set it on the box for later use. Carefully set the tube in the box hole with open end up.

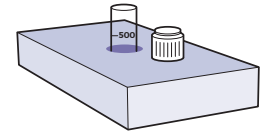

### 6 Get Blood Flowing

- Assume a standing position during the collection.
- Select the arm you want to use.
- Rotate that arm in a circle multiple times.
- Make a fist and open and close tightly 10 times.

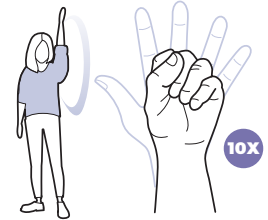

## COLLECTION

### 1 Prepare Finger for Collection

- Pull the cap off the lancet.
- Select either the middle or ring finger to draw blood.
- Locate the **top outside portion** of your fingertip.
- Clean fingertip with alcohol wipe and let alcohol dry.



### 2 Collect Blood

- The lancet works automatically.
- Press the red end of the lancet firmly against your finger and apply a large amount of pressure until you hear the lancet click. Blood will begin to flow right away.
- Immediately put your arm and hand in a downward position.

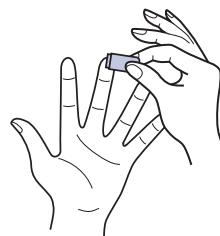

### 3 Collect Blood (cont'd)

- Start applying pressure from the top of your finger below the knuckle and massage downward toward your fingertips.
- Press firmly at the fingertip until a full blood drop forms and collect in the tube.
- Continue massaging as needed to keep blood flowing until sample collection is complete.
- Collect blood for 2-10 minutes, until the 500 line on the tube is reached. This may require repeating the process with a new lancet and different finger.
- Apply pressure to tip of finger for 10 seconds, wipe excess blood with alcohol swab, and apply a bandage.
- If liquid preservative solution comes in contact with skin or eyes, rinse off immediately. If a spill occurs on clothing, wash before reuse.

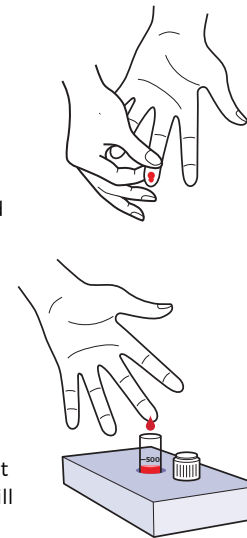

### 4 Mix Blood Preservative

- Snap red cap back on the collection tube.
- Tap the tube on the clean surface to break up any blood clots.
- Invert tube upside down, making blood flow freely towards top.
- Revert tube right-side up, making blood flow freely towards bottom.
- Repeat 10 times (upside down and then right-side up counts as one time).

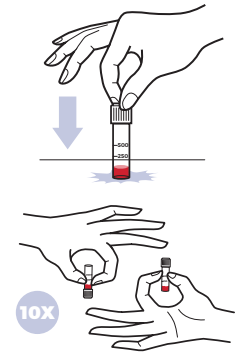

## RETURN

### 1 Package Sample for Shipment

- Clean any excess blood from collection tube.
- Place collection tube into resealable plastic bag and place the **Consent Card** in the original box.

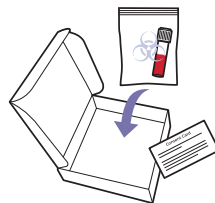

### 2 Package Sample for Shipment (cont'd)

- Place original box into the prepaid shipping package provided by DDC and seal.



### 3 Return Sample

- To preserve the integrity of the sample, keep package in a temperature controlled environment at all times.
- Ship prepaid package at your local shipping center.

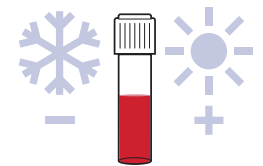

### 4 Receive your Report

Once your package arrives at the lab, you are notified via email. When testing is complete, the results will be emailed to you.

#### IMPORTANT

You must register your sample at [PeekabooGenderTest.com/Register](https://PeekabooGenderTest.com/Register) and your completed Consent Card **MUST** be included with your sample to receive results.